

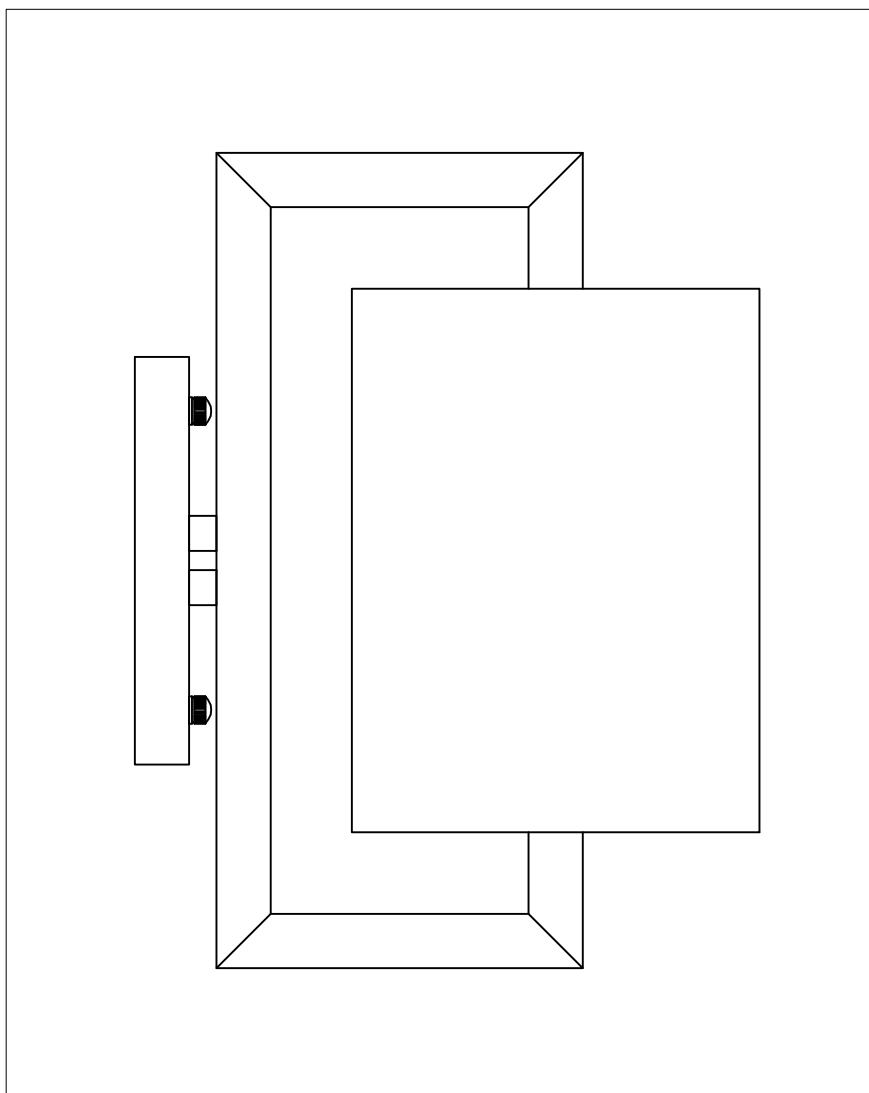

**PRODUCT NAME:**Baldwin  
**ITEM NUMBER:** 43551

**Please consult your electrician for hanging fixture and wiring.**



**Bulb(included): 1 x GU24 LED 9W**

**IMPORTANT: Turn off the power at the main fuse or circuit breaker box before starting installatio**

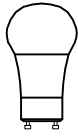

(A)GU 24 Bulb

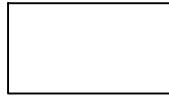

(B)Shade

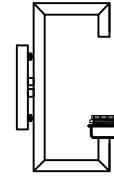

(C)Body

**Locate all hardware & components before discarding packaging**

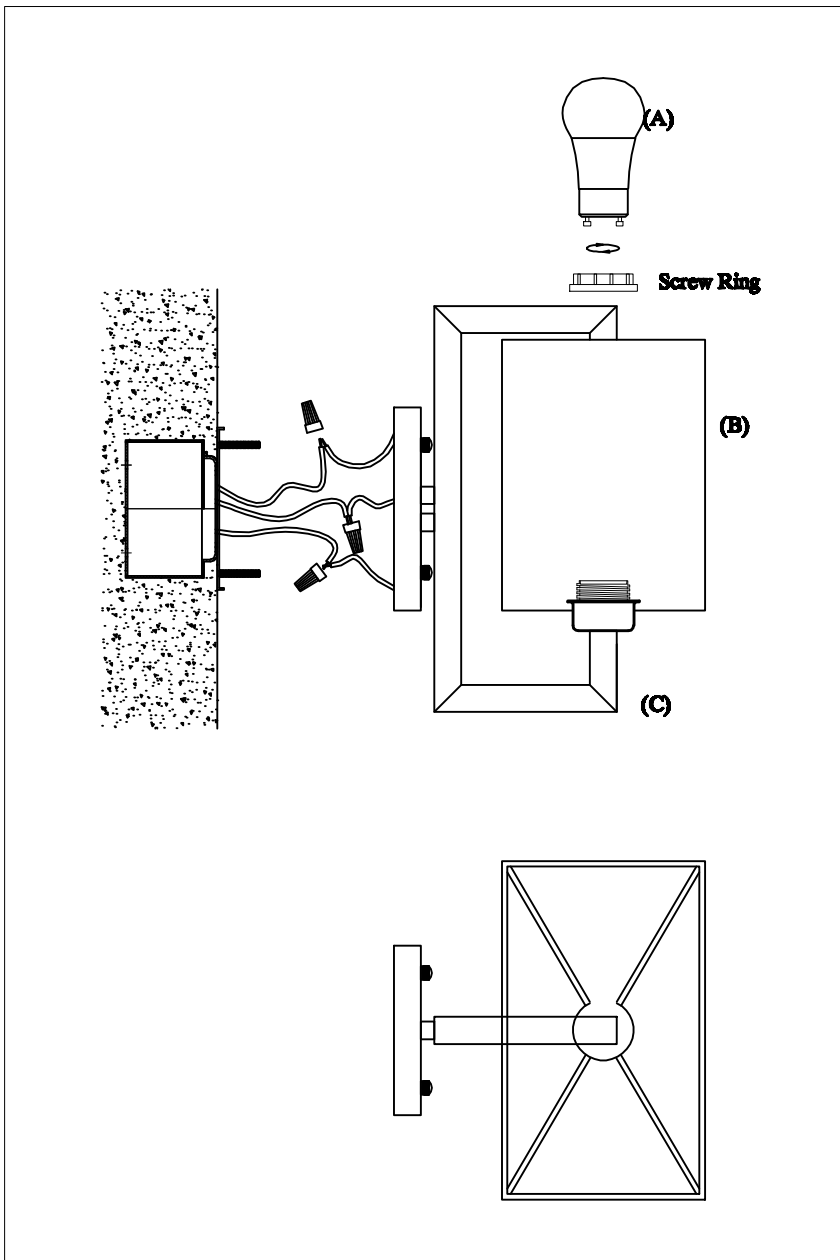

1.)

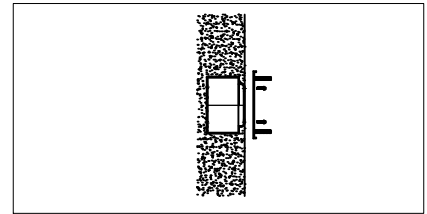

**Step.1:Remove mounting bracket from fixture and install to electrical box**

2.)

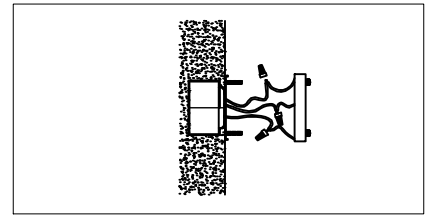

**Step.2:Wire fixtures to wires in outlet box. Copper/green wire is for ground. Install body (C) to bracket and tighten screws on the backplate to secure.**

3.)

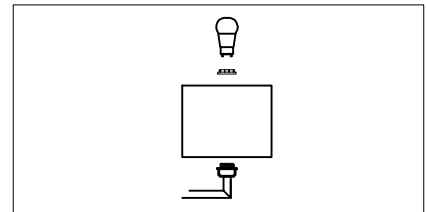

**Step.3: Secure the lamp shade (B) to the body (C) using the screw ring around the socket. Install the LED GU24 bulbs (A) provided.**

**Cleaning & Care:**  
Clean with soft cloth and a mild detergent.  
Do not use abrasive cleaner.