

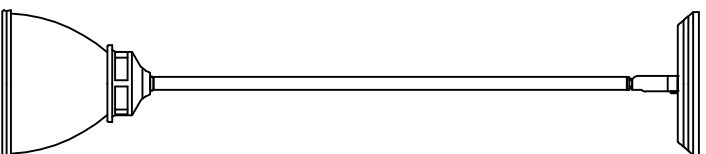

**PRODUCT NAME : Novus Mini Pendant**  
**ITEM NUMBER: 91580**

**Please consult your electrician for hanging fixture and wiring.**



**1\*E26\*60W (NO INCLUDED BULB)**

Locate all hardware & components before discarding packaging  
Cleaning & Care:  
Clean with soft cloth and a mild detergent.  
DO not use abrasive cleaner.

**PRODUCTS ARE NOT INTENDED  
FOR COMMERCIAL USE.**

**MADE IN CHINA**  
**Page 1 of (2)**



**PRODUCT NAME : Novus Mini Pendant**  
**ITEM NUMBER: 91580**

**CAUTION:** Turn off the main power at the circuit breaker before installing and servicing the fixture to prevent possible injury from electric shock.  
All electrical connections must be in accordance with local and National Electrical Code (N.E.C.) standards.  
If you are unfamiliar with proper electrical wiring connections, obtain the services of a qualified electrician.

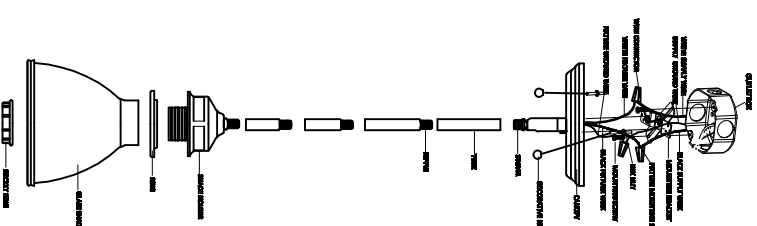

1. Remove mounting bracket from fixture and install to electrical box
2. Run wire through stems and combine stem lengths to meet desired mounting height.
3. Wire fixture to wires in outlet box. Green wire is for Ground.
4. Install fixture to bracket and tighten screws at the ends of the canopy to secure.

**PRODUCTS ARE NOT INTENDED  
FOR COMMERCIAL USE.**

**MADE IN CHINA**  
**Page 2 of (2)**