

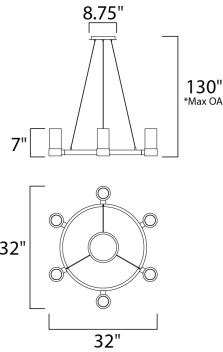

**PRODUCT DESCRIPTION**

The Silo collection makes artful use of thin-profile rectangular tubing with a mirror-like Polished Chrome finish for a clean, contemporary look. A subtle Frost on the underside of the two cylindrical glass shades adds softness to the sleek lines, while the bright Xenon lamps are cleverly concealed in the cast metal ring allowing ample light to cast both upwards and downwards without glare.



\*max overall height

**MEASUREMENTS**

- DIMENSION : 32" W x 7" H
- MAX OAH : 130" OAH
- CANOPY : 8.75" W
- HANGING WEIGHT : 14.96 lb

**LAMPING**

- INPUT VOLTAGE : 120V
- BULB : 8 x 2W LED G9 , 16W Total
- BULB INCLUDED : (Included)
- DIMMABLE : Yes
- COLOR\_TEMP : 3000K

**FINISHES OPTION**

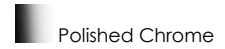

**GLASS**

Clear and Frosted CLFT

**MATERIAL**

Metal, Glass

**RATINGS**

cETLus  
Dry Location



**ADDITIONAL**

OPERATING TEMPERATURE:  
-20°C (-4°F), 40°C (104°F)

Always consult a qualified electrician before installing any lighting product.



**WESTERN DISTRIBUTION CENTER (HEADQUARTER)**  
253 NORTH VINELAND AVE | CITY OF INDUSTRY, CA 91746  
**EASTERN DISTRIBUTION CENTER**  
4200 SHIRLEY DR. | ATLANTA, GA 30336  
P. 626.956.4200 | F. 626.956.4225 | maximlighting.com