

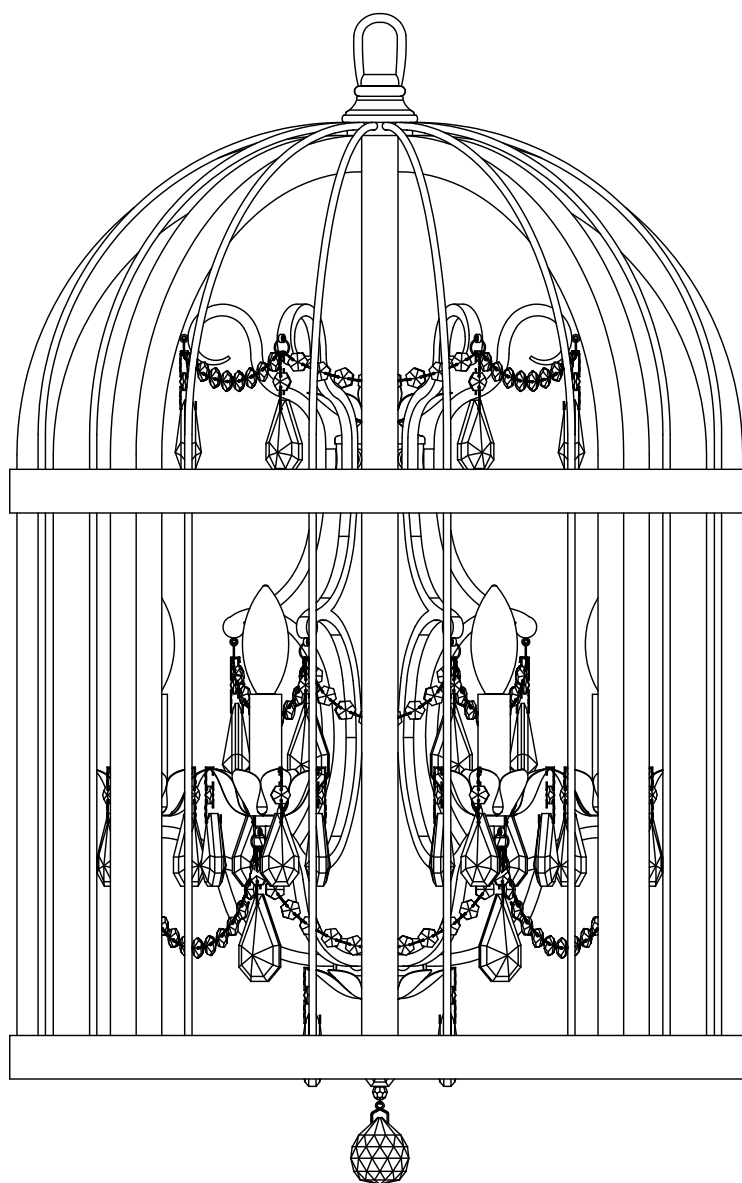

**PRODUCT NAME: MIRANDA**

**ITEM NUMBER: 32514APBY**

**Please consult your electrician for hanging fixture and wiring.**



**E12 6X60W**

**IMPORTANT: Turn off the power at the main fuse or circuit breaker box before starting installation.**

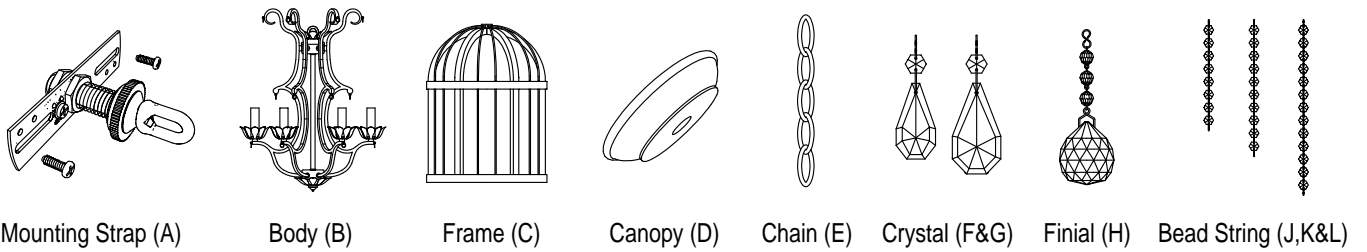

**Locate all hardware & components before discarding packaging**

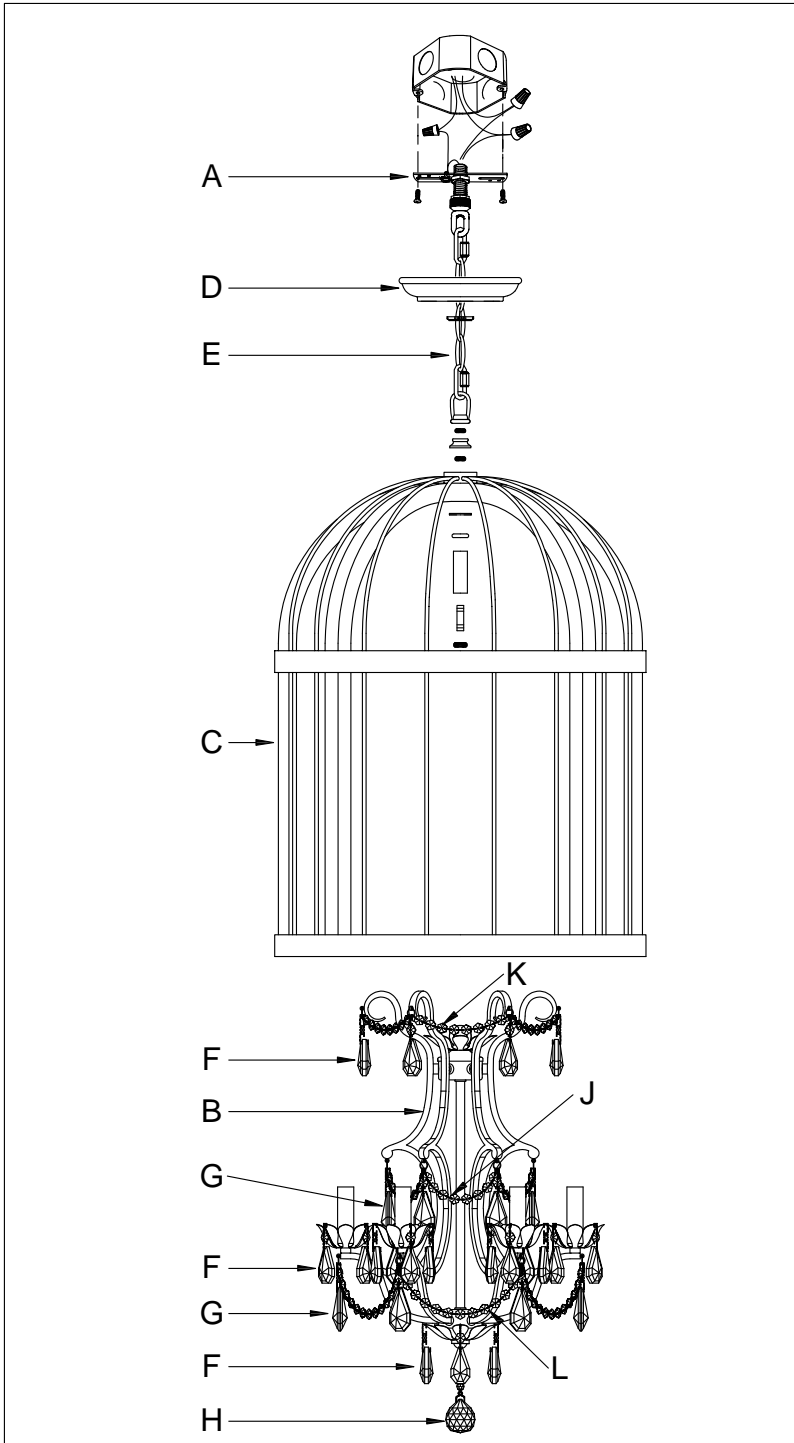

**Cleaning & Care:**  
Clean with soft cloth and a mild detergent.  
Do not use abrasive cleaner.

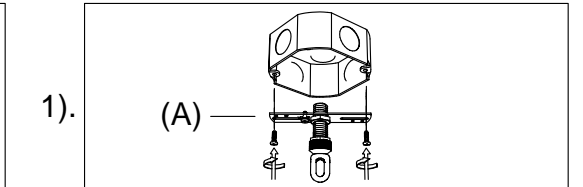

1). (A) —  
Step.1: Remove mounting bracket (A) from fixture and install to electrical box.

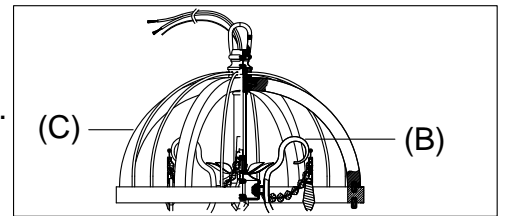

2). (C) — (B) —  
Step.2: Place body(B) into frame (C) and secure with nut.

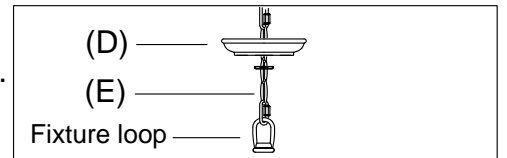

3). (D) — (E) —  
Fixture loop —  
Step.3: Install fixture loop. Connect chain (E) to fixture loop and canopy loop with key link. Thread fixture wire through the chain (E) into outlet box.

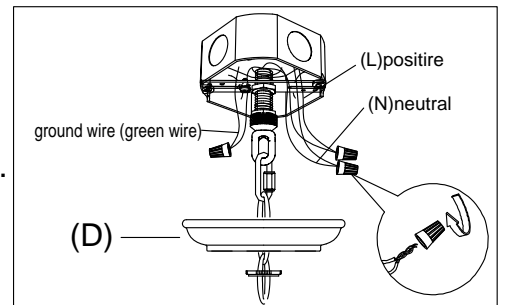

4). (D) —  
Step.4: Wire fixture to wires in outlet box. Green wire is fo Ground.

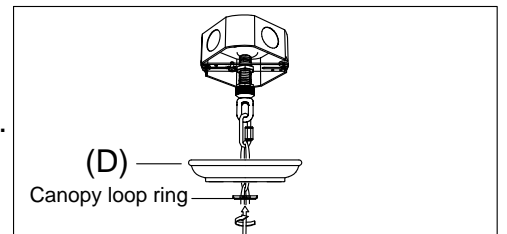

5). (D) —  
Canopy loop ring —  
Step.5: Raise Canopy (D) to ceiling and secure with canopy loop ring. Install light bulb. Hook crystal (F&G), finial (H) and bead string (J,K&L) on the body.