

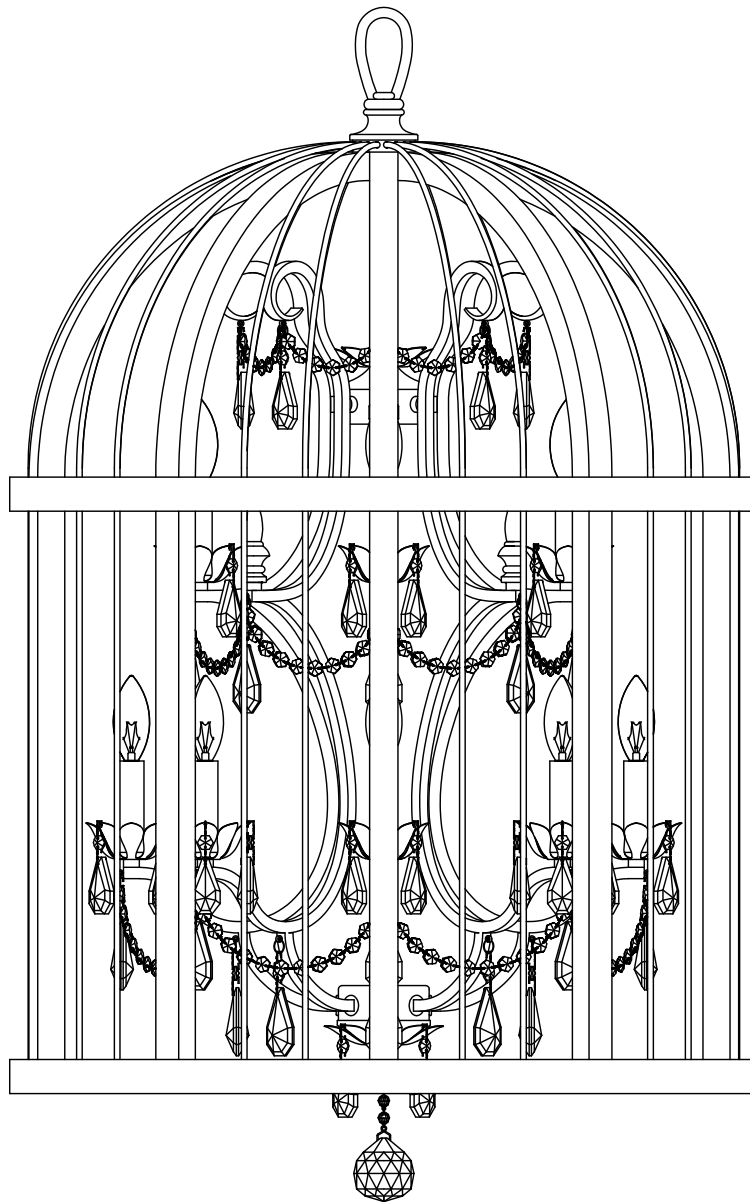

PRODUCT NAME: MIRANDA

ITEM NUMBER: 32516APBY

Please consult your electrician for hanging fixture and wiring.



E12 12X60W

IMPORTANT: Turn off the power at the main fuse or circuit breaker box before starting installation.

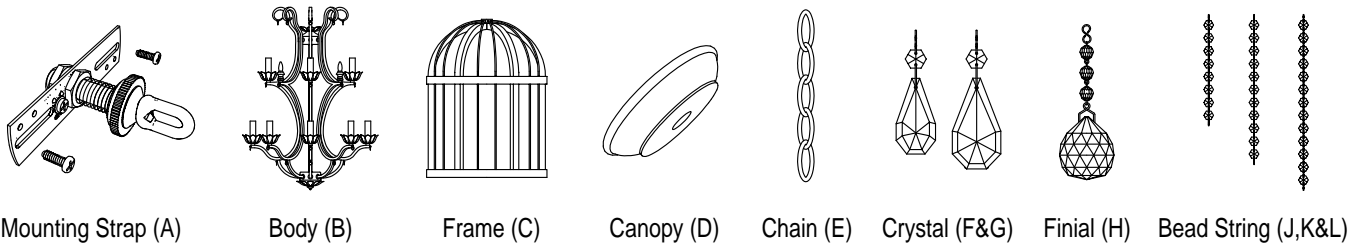

Locate all hardware & components before discarding packaging

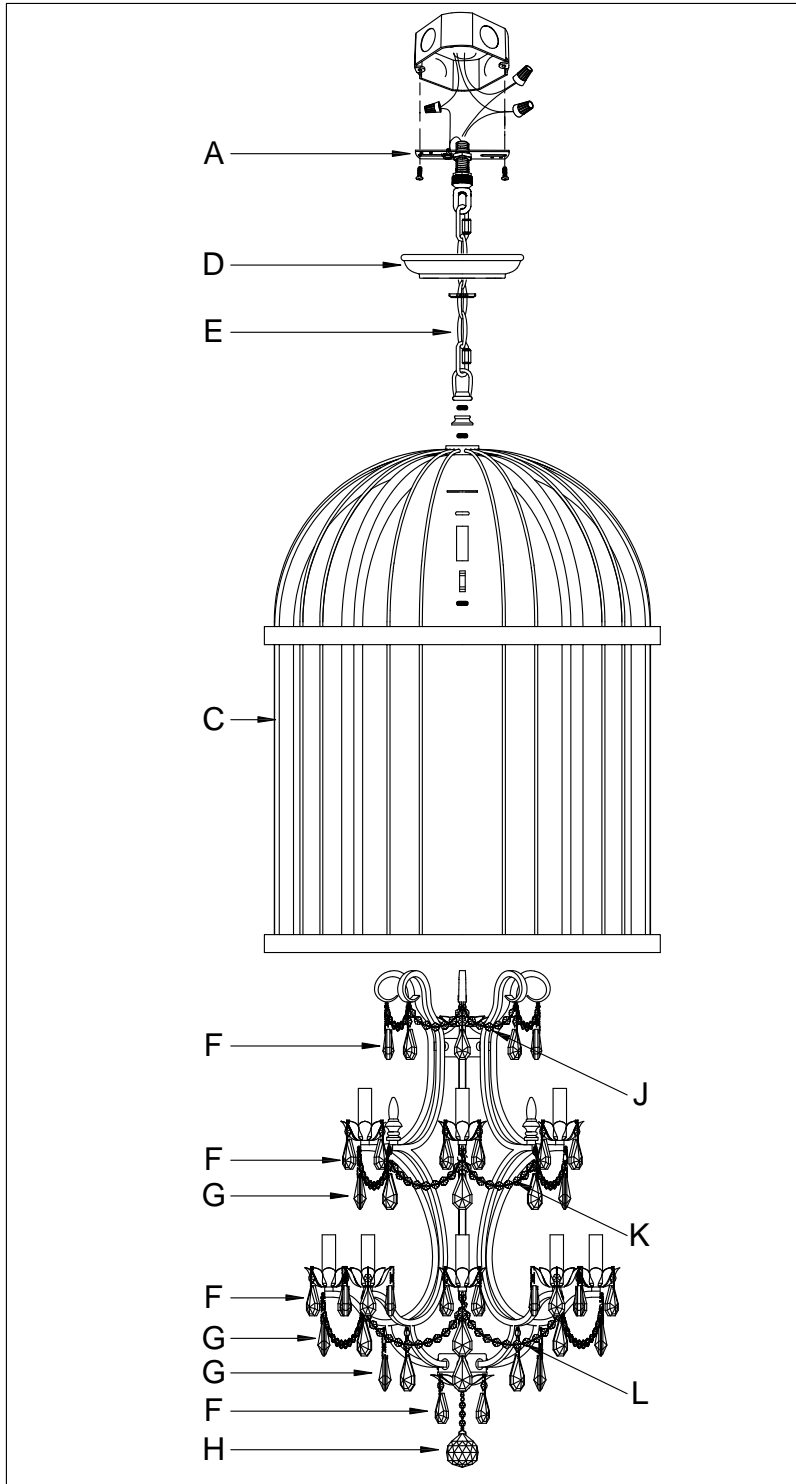

Cleaning & Care:

Clean with soft cloth and a mild detergent.
Do not use abrasive cleaner.

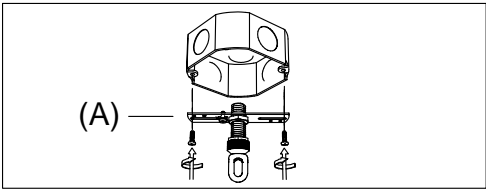
1. 

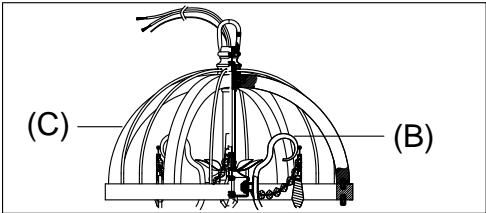
Step.1: Remove mounting bracket (A) from fixture and install to electrical box.
2. 

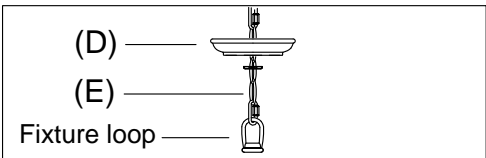
Step.2: Place body(B) into frame (C) and secure with nut.
3. 

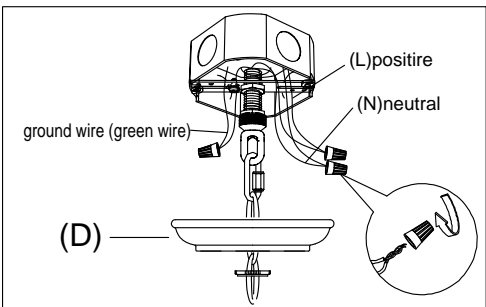
Step.3: Install fixture loop. Connect chain (E) to fixture loop and canopy loop with key link. Thread fixture wire through the chain (E) into outlet box.
4. 

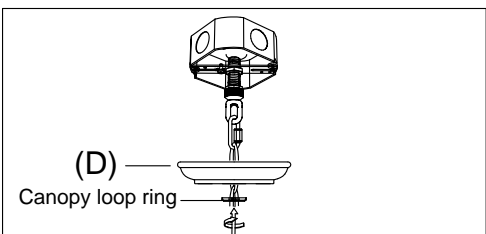
Step.4: Wire fixture to wires in outlet box. Green wire is for Ground.
5. 

Step.5: Raise Canopy (D) to ceiling and secure with canopy loop ring. Install light bulb. Hook crystal (F&G), finial (H) and bead string (J,K&L) on the body.