

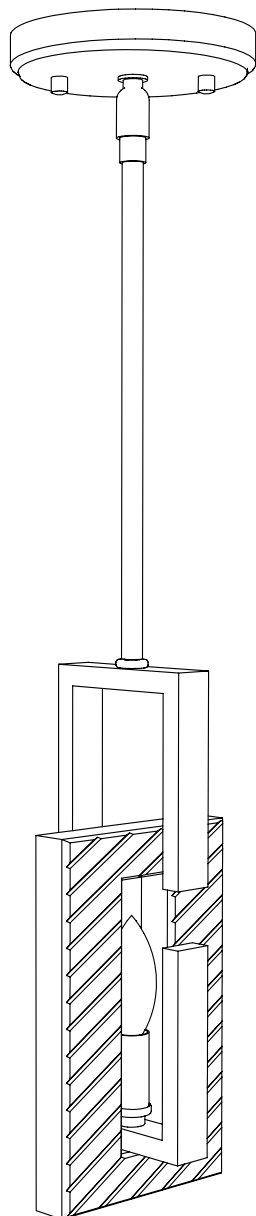

**PRODUCT NAME: SUAVE**

**ITEM NUMBER: 38013BCPN**

**Please consult your electrician for hanging fixture and wiring.**



**E12 1X60W (No bulb included)**

**IMPORTANT: Turn off the power at the main fuse or circuit breaker box before starting installation.**

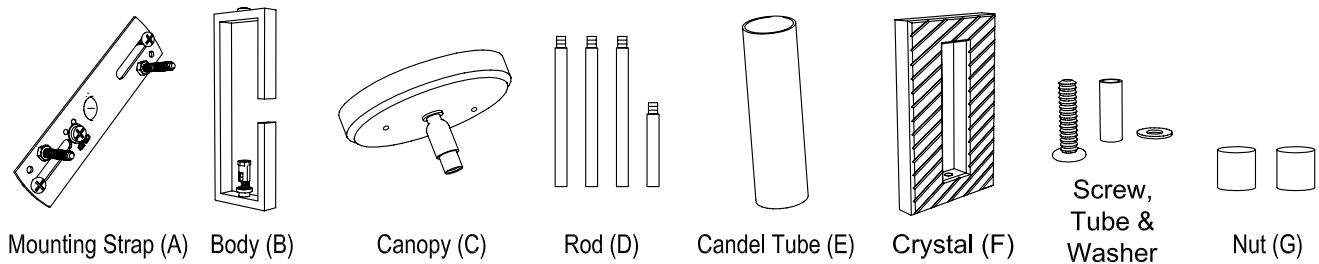

**Locate all hardware & components before discarding packaging**

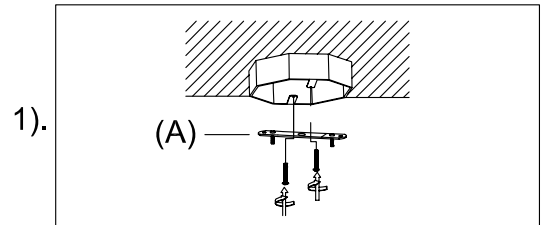
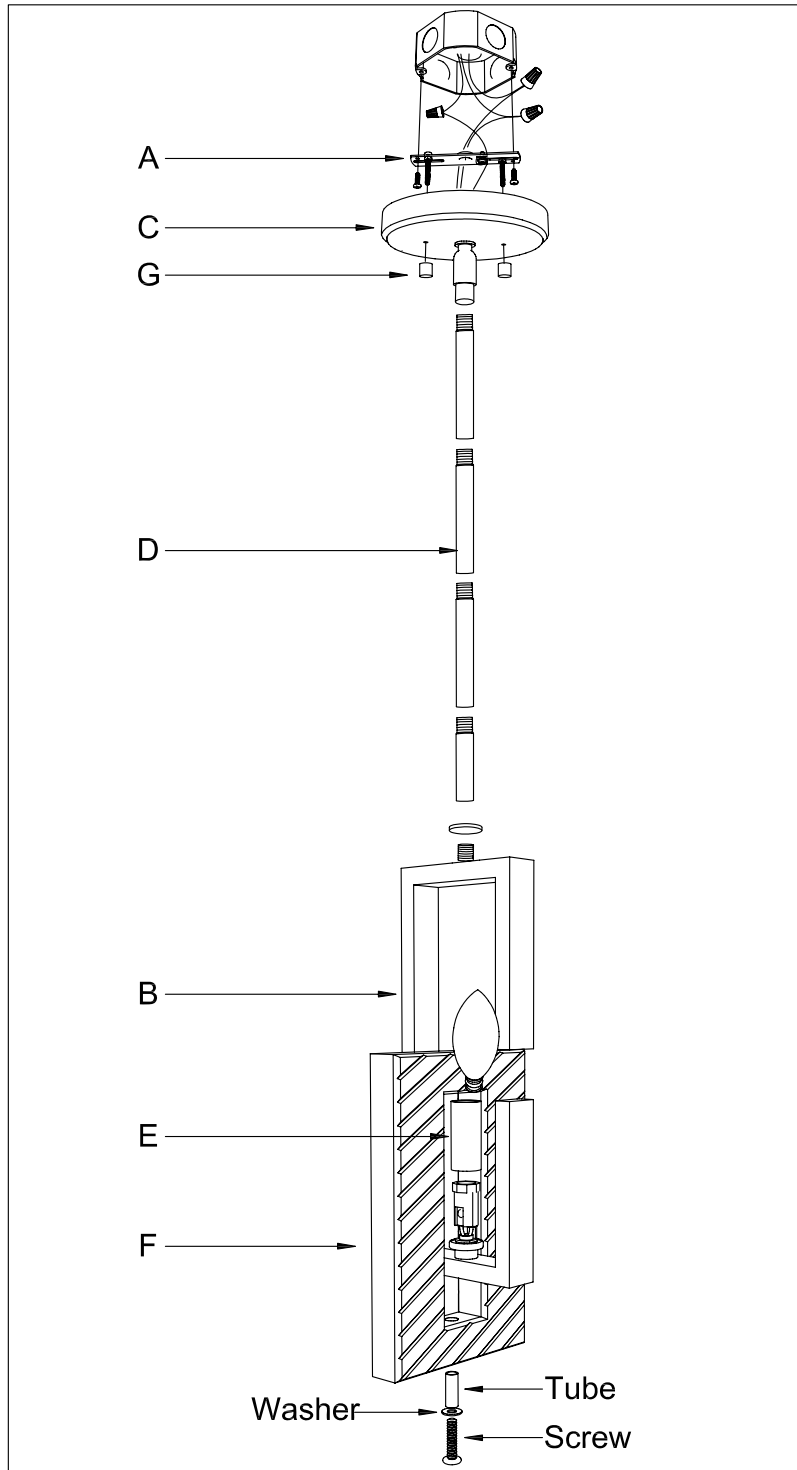

Step.1: Remove Mounting Strap (A) from fixture and install to electrical box.

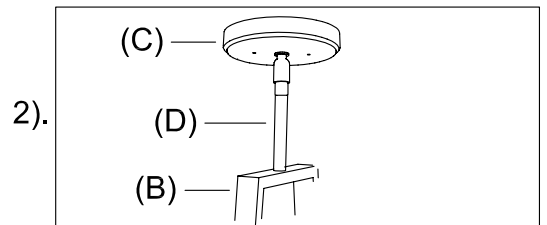

Step.2: Determine correct length of rod needed for hanging height. Screw the Rod (D) on the Body (B) and Canopy (C).

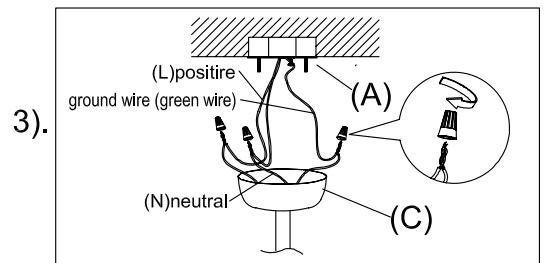

Step.3: Wire fixture to wires in outlet box. Green wire is for Ground.

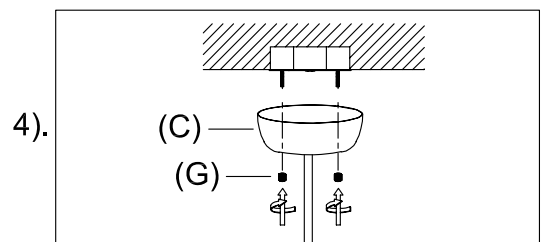

Step.4: Install body (B) to Mounting Strap (A) and tighten nut (G) on the canopy to secure. Install Crystal (F) on the body and secure with tube, washer & screw. Place the Candle Tube (E) over the socket and Install light bulb.

#### **Cleaning & Care:**

Clean with soft cloth and a mild detergent.  
Do not use abrasive cleaner.