

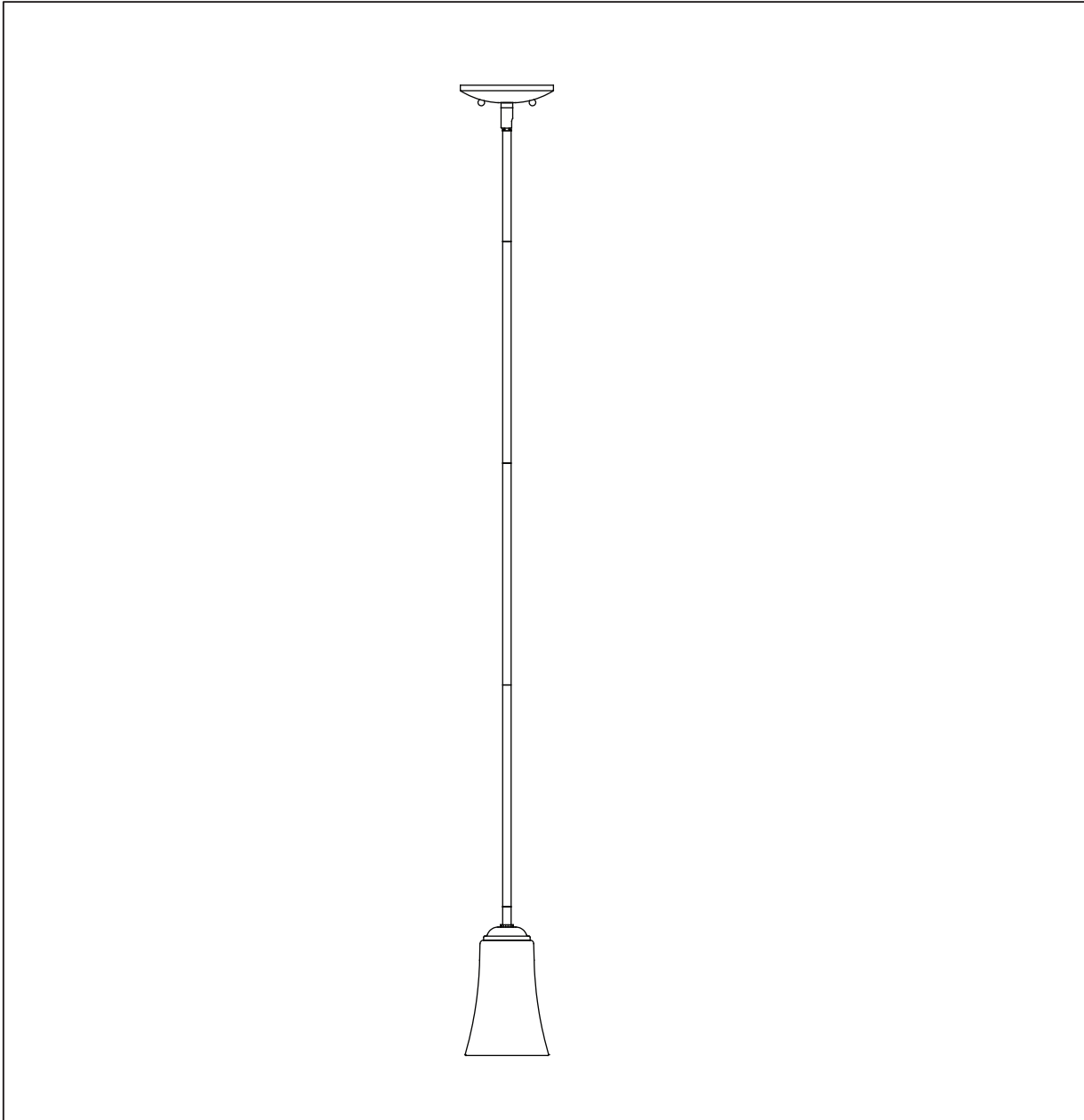

PRODUCT NAME: Logan 1-Light Mini Pendant  
ITEM NUMBER: 92040

Please consult your electrician for hanging fixture and wiring.



Bulb (not included): 1x60W Medium Base Bulb

**IMPORTANT:** Turn off the power at the main fuse or circuit breaker box before starting installation

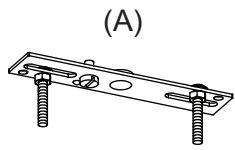

(A)  
Bracket

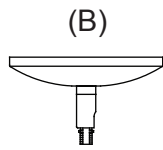

(B)  
Canopy



(C)  
Ball Nuts(2Pcs)



(E)  
Mounting Screws(2Pcs)

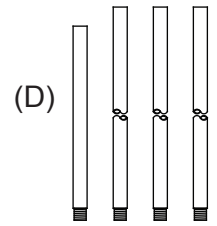

(D)  
Rods(1\*6" +3\*12")\*1

Locate all hardware & components before discarding packaging

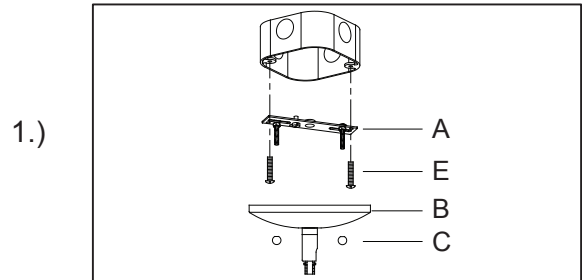
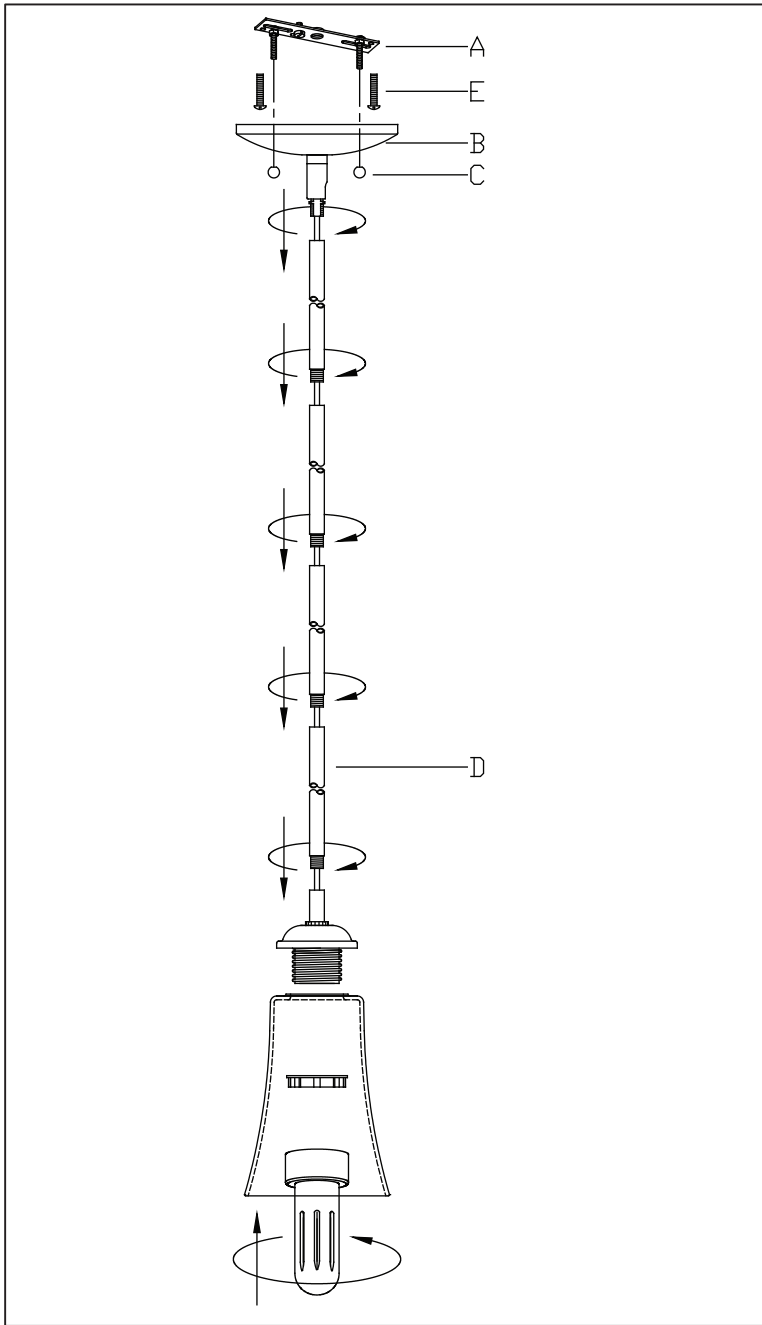

1.)

Step1:Remove mounting bracket from fixture and install to electrical box.

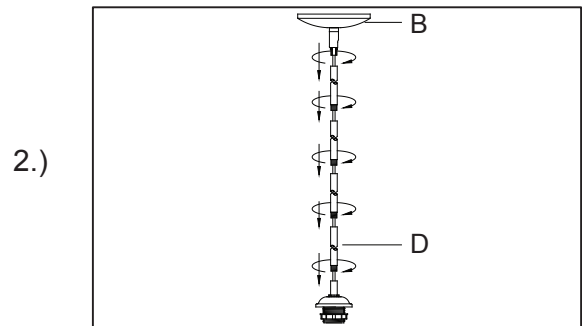

2.)

Step2:Run wire through stems and combine stem lengths to meet desired mounting height.

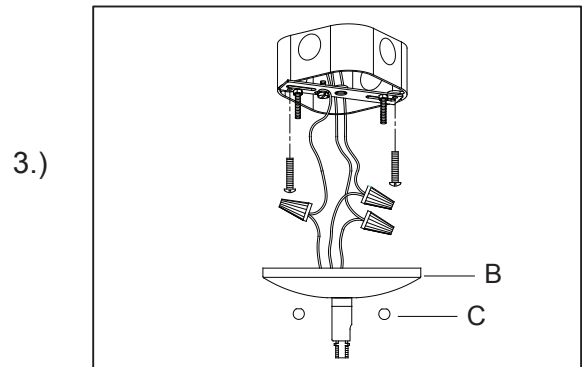

3.)

Step3:Wire fixture to wires in outlet box. Copper wire is for Ground. Attach canopy to mounting bracket and tighten with ball nuts.

**Cleaning & Care:**  
Clean with soft cloth and a mild detergent.  
Do not use abrasive cleaner.