

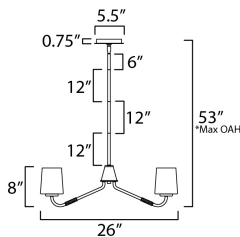

PRODUCT DESCRIPTION

Featuring knurled rod details, this lighting collection brings a modern industrial edge to any space. Available in a range of sizes for chandeliers and two styles of bath vanity lighting, it offers versatility for different design needs. Offered in Matte Black, Satin Nickel, and Natural Aged Brass, this collection complements a wide variety of interior styles.



*max overall height

MEASUREMENTS

DIMENSION : 26" L x 26" W x 8" H
MAX OAH : 53" OAH
CANOPY : 5.5" W x 0.75" H x 5.5" L
HANGING WEIGHT : 6.6 lb

LAMPING

INPUT VOLTAGE : 120V
BULB : 5 x 60W Incandescent E26 Medium , 300W Total
BULB INCLUDED : (Not Included)
DIMMABLE : Triac or ELV (Phase Dim)
LIGHTING_DIRECTION : Up

FINISHES OPTION

- Black (BK)
- Natural Aged Brass (NAB)
- Polished Chrome (PC)
- Satin Nickel (SN)

GLASS

White WT

MATERIAL

Steel, Glass

RATINGS

cETLus
Dry Location



ADDITIONAL

INSTALL UP/DOWN: Down
OPERATING TEMPERATURE:
-20°C (-4°F), 40°C (104°F)

Always consult a qualified electrician before installing any lighting product.



WESTERN DISTRIBUTION CENTER (HEADQUARTER)
253 NORTH VINELAND AVE | CITY OF INDUSTRY, CA 91746
EASTERN DISTRIBUTION CENTER
101 GARDNER PARK | PEACHTREE CITY, GA 30269
P. 626.956.4200 | F. 626.956.4225 | maximlighting.com