

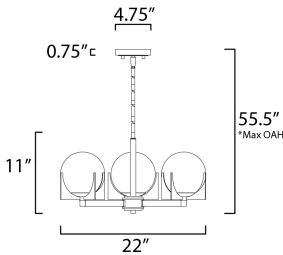

PRODUCT DESCRIPTION

A homage to Mid-Century Modern design, the Finn collection features large Satin White opal glass shades on a contemporary finish combination of Satin Brass and Brushed Platinum. The glass shades are embraced by laser cut fins to create a clean, yet dramatic look.



*max overall height

MEASUREMENTS

- DIMENSION : 22" L x 22" W x 11" H
- MAX OAH : 55" OAH
- CANOPY : 4.75" W x 0.75" H x 4.75" L
- HANGING WEIGHT : 5.73 lb

LAMPING

- INPUT VOLTAGE : 120V
- BULB : 3 x 40W Incandescent E12 Candelabra , 120W Total
- BULB INCLUDED : (Not Included)
- DIMMABLE :

FINISHES OPTION

- Satin Brass / Brushed Platinum (SBRBP)

GLASS

- Satin White SW

MATERIAL

- Steel, Glass

RATINGS

- cULus
- Dry Location



ADDITIONAL

- ADJUSTABLE
- SLOPE: 90
- OPERATING TEMPERATURE: -20°C (-4°F), 40°C (104°F)

Always consult a qualified electrician before installing any lighting product.



WESTERN DISTRIBUTION CENTER (HEADQUARTER)
253 NORTH VINELAND AVE | CITY OF INDUSTRY, CA 91746
EASTERN DISTRIBUTION CENTER
101 GARDNER PARK | PEACHTREE CITY, GA 30269
P. 626.956.4200 | F. 626.956.4225 | maximlighting.com