

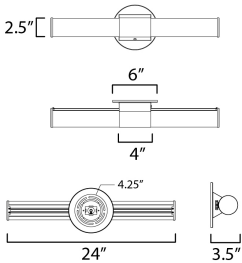

PRODUCT DESCRIPTION

A tube of light extends in both directions in this clean and contemporary LED wall sconce. Available in various lengths and finishes, the fixture can either be mounted directly from its frame on a single gang box or with the use of the five inch cover plate provided for standard junction boxes. Select from 5 different color temperatures using an easily accessible switch on the frame.



MEASUREMENTS

DIMENSION : 24" W x 3" H x 3.5" Ext
BACK PLATE : 6" W x 6" H
HANGING WEIGHT : 1.68 lb

LAMPING

INPUT VOLTAGE : 120V
LUMENS : 2,100 Rated (1,700 Del.)
BULB : 1 x 24W LED AC Integrated , 24W Total
BULB INCLUDED : (Integrated)
DIMMABLE : Triac or ELV
CRI : 90 CRI
COLOR_TEMP : 27-30-35-40-50K

FINISHES OPTION

- Black (BK)
- Natural Aged Brass (NAB)
- Polished Chrome (PC)
- Satin Nickel (SN)

GLASS

White WT

MATERIAL

PMMA Acrylic, Aluminum

RATINGS

cETLus
Damp Location
ADA



ADDITIONAL

INSTALL UP/DOWN: Any
RATED LIFE 50000 Hours
OPERATING TEMPERATURE:
-20°C (-4°F), 40°C (104°F)

Always consult a qualified electrician before installing any lighting product.



WESTERN DISTRIBUTION CENTER (HEADQUARTER)
253 NORTH VINELAND AVE | CITY OF INDUSTRY, CA 91746
EASTERN DISTRIBUTION CENTER
101 GARDNER PARK | PEACHTREE CITY, GA 30269
P. 626.956.4200 | F. 626.956.4225 | maximlighting.com