

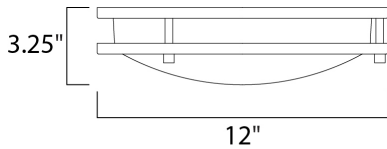

PRODUCT DESCRIPTION

Commercial grade energy efficient lighting featuring linear frames of metal finished in Satin Nickel diffused by an etched opal acrylic creating an updated energy efficient classic.



MEASUREMENTS

DIMENSION : 12" L x 12" W x 3.25" H
HANGING WEIGHT : 1.68 lb

LAMPING

INPUT VOLTAGE : 120-277V
LUMENS : 950 Rated
BULB : 1 x 15W LED PCB Integrated , 15W Total
BULB INCLUDED : (Integrated)
DIMMABLE : N
CRI : 90+ CRI
COLOR_TEMP : 3000K

FINISHES OPTION

 Satin Nickel (SN)

GLASS

White WT

MATERIAL

Steel, Opal Acrylic

RATINGS

cETLus
Damp Location



ADDITIONAL

OPERATING TEMPERATURE:
-20°C (-4°F), 40°C (104°F)

PHOTOMETRIC: Report Found Online

Always consult a qualified electrician before installing any lighting product.



WESTERN DISTRIBUTION CENTER (HEADQUARTER)
253 NORTH VINELAND AVE | CITY OF INDUSTRY, CA 91746

EASTERN DISTRIBUTION CENTER
101 GARDNER PARK | PEACHTREE CITY, GA 30269

P. 626.956.4200 | F. 626.956.4225 | maximlighting.com