

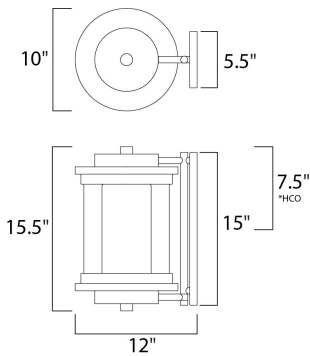

PRODUCT DESCRIPTION



*height from center of outlet to the top of the fixture

MEASUREMENTS

DIMENSION : 10" W x 15.5" H x 12" Ext
BACK PLATE : 5.5" W x 15" H x 7.5" HCO
HANGING WEIGHT : 11.8 lb

LAMPING

INPUT VOLTAGE : 120V
LUMENS : 1,100 Rated
BULB : 1 x 12W LED GU24 , 12W Total
BULB INCLUDED : (Included)
DIMMABLE : Triac CL
CRI : 80+ CRI
COLOR_TEMP : 3000K

FINISHES OPTION

Anthracite (AR)

GLASS

Clear and Frosted CLFT

MATERIAL

Die Cast Aluminum

RATINGS

cETLus
Wet Location



ADDITIONAL

RATED LIFE 25000 Hours
OPERATING TEMPERATURE:
-20°C (-4°F), 40°C (104°F)

Always consult a qualified electrician before installing any lighting product.



WESTERN DISTRIBUTION CENTER (HEADQUARTER)
253 NORTH VINELAND AVE | CITY OF INDUSTRY, CA 91746
EASTERN DISTRIBUTION CENTER
101 GARDNER PARK | PEACHTREE CITY, GA 30269
P. 626.956.4200 | F. 626.956.4225 | maximlighting.com